

# NET0950 Fırdöndü Mapa - Grade 80

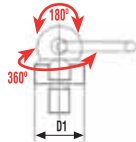
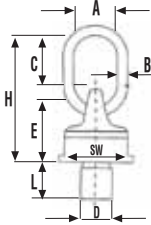

Art.No.	Ölçü	Kapasite (t)	Ölçüler (mm)								Ağırlık (kg)
			A	B	C	E	H	SW	D1		
3950 00 30	M10x18	0.3	30	13	46	50	105	30	38	0.480	
3950 00 50	M12x18	0.5	30	13	46	50	105	30	38	0.500	
3950 00 52	M12x25	0.5	30	13	46	50	105	30	38	0.500	
3950 01 25	M16x20	1.12	30	13	46	50	105	30	38	0.530	
3950 01 26	M16x30	1.12	30	13	46	50	105	30	38	0.530	
3950 01 50	M20x30	1.12	30	13	46	50	105	30	38	0.530	
3950 02 00	M20x30	2	34	16	57	61	131	40	50	1.050	
3950 03 00	M24x30	3.15	40	19	70	68	153	48	58	1.630	
3950 05 00	M30x35	5.3	40	20	65	80	165	65	75	2.230	
3950 05 02	M30x45	5.3	40	20	65	80	165	65	75	2.230	
3950 08 00	M30x35	8	50	22	90	95	205	75	85	5.300	
3950 08 01	M30x45	8	50	22	90	95	205	75	85	5.300	
3950 08 02	M36x54	8	50	22	90	95	205	75	85	5.500	
3950 10 42	M42x63	10	50	22	90	95	205	75	85	10.000	
3950 15 01	M48x60	15	70	30	120	130	280	95	120	10.000	
3950 15 56	M56x78	15	70	30	120	130	280	95	120	10.000	
3950 15 64	M64x96	15	70	30	120	130	280	95	120	10.000	
3950 15 72	M72x108	25	68	40	127	165	338	134	160	29.000	
3950 15 80	M80x120	30	68	40	127	165	338	134	170	29.000	
3950 15 90	M90x135	35	68	40	127	165	338	134	170	29.000	

Emniyet kat sayısı : 4:1

EN1677 standardına göre tasarlanmıştır, test edilmiş ve belgelendirilmiştir.

## Kapasite (t)



0° Tek Bacak	0° İki Bacak	90° Tek Bacak	90° İki Bacak	0-45° İki Bacak	45-60° İki Bacak	Asimm	0-45° 3-4 Bacak	45-60° 3-4 Bacak	Asimm
0.6	1.2	0.3	0.6	0.42	0.3	0.3	0.63	0.45	0.3
1	2	0.5	1	0.75	0.5	0.5	1.1	0.75	0.5
1	2	0.5	1	0.75	0.5	0.5	1.1	0.75	0.5
2	4	1.12	2	1.5	1.12	1.12	2.36	1.6	1.12
2	4	1.12	2	1.5	1.12	1.12	2.36	1.6	1.12
2	4	1.12	2	1.5	1.12	1.12	2.36	1.6	1.12
4	8	2	4	2.8	2	2	4	3	2
6.3	12.5	3.15	6.3	4.25	3.15	3.15	6.3	4.75	3.15
10.6	21.2	5.3	10.6	7.1	5.3	5.3	11.2	8	5.3
10.6	21.2	5.3	10.6	7.1	5.3	5.3	11.2	8	5.3
12.5	25	8	12.5	11.2	8	8	16.8	12	8
12.5	25	8	12.5	11.2	8	8	16.8	12	8
12.5	25	8	12.5	11.2	8	8	16.8	12	8
15	30	10	15	14	10	10	21.2	15	10
25	50	15	25	21	15	15	31.5	22.5	15
25	50	15	25	21	15	15	31.5	2.5	15
25	50	15	25	21	15	15	31.5	22.5	15
35	70	25	35	35	25	25	52.5	37.5	25
35	70	30	35	42	30	30	63	45	30
35	70	35	35	49	35	35	73.5	52.5	35